

Door System has invested a lot of resources in developing and testing EI<sub>2</sub>60-C fire doors and fire sliding doors according to the new European standard and we continue to do so. We can advise you when investing in fire solutions and can also help get the necessary approvals from the fire authorities. We have collected relevant data below on our fire doors and fire sliding doors.

### Fire approvals according to EN 16034 and EN 13501-2 (European fire approval)

EI<sub>2</sub>60-C hinged fire door, 1-leaf, min. size 0.23x0.65 m, max. size 1.40x2.95 m, though max 3.46 m<sup>2</sup> (clear opening).

EI<sub>2</sub>60-C hinged fire door, 2-leaves, min. size 0.98x1.90 m, max. size 2.20x2.30 / 1.96x2.54 m (clear opening).

EI<sub>2</sub>60-C fire sliding door, 1-leaf, max. size 3.70x4.60 m (clear opening).

Certified and CE marked.

### U-value

EI<sub>2</sub>60-C hinged fire door with reference size 1.23x2.18 m (according to BR18): 1.18 W/m<sup>2</sup>K

### Frames

Frames are made of stainless steel. Fire door frames according to EN 16034 and EN 13501-2 can be produced larger than specified dimensions. Do not change frames according to DS 1052.2.

### Fire approvals according to DS 1052.2 (Danish fire approval):

BD30 hinged fire door, 1-leaf, max size 1.23x2.37 m (door plate dimensions).

BS60 hinged fire door, 1-leaf, max. size 1.02x2.10 m (clear opening).

BS60 hinged fire door, 2-leaves, max. size (2x1.02) x2.10 m (clear opening).

BS60 fire sliding door, 1 leaf, max. size 4.80x3.60 m (wall opening).

Certified and marked with a DS mark.

Approval only applies to doors mainly intended for pedestrian use. For hinged doors, it only applies to internal doors (external hinged doors must be CE marked).

### Surface Material

Stainless steel, stainless acid-resistant steel, galvanized steel, lacquered steel in standard RAL color and Food-Safe (available in white, gray and blue)(frames are always made of stainless steel).

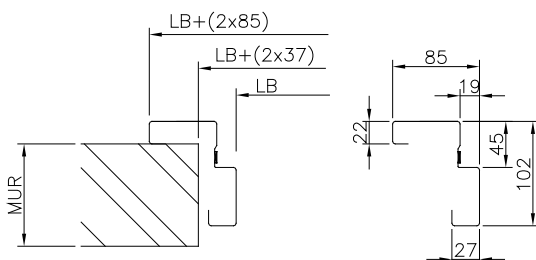

Type C, EI<sub>2</sub>60, hinged door

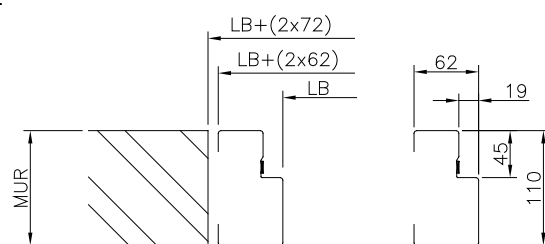

Type D, EI<sub>2</sub>60, hinged door

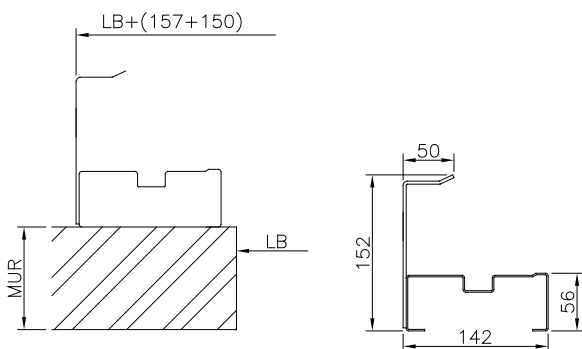

Type EI<sub>2</sub>60, fire sliding door (front edge)

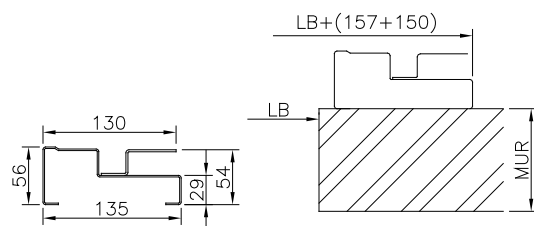

Type EI<sub>2</sub>60, fire sliding door (rear edge)

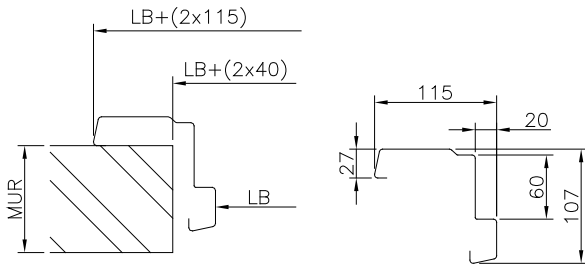

Type B, BS60, hinged door

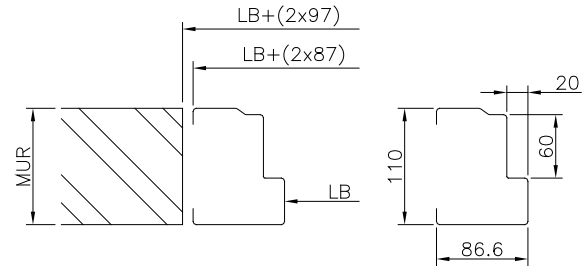

Type B2, BS60, hinged door

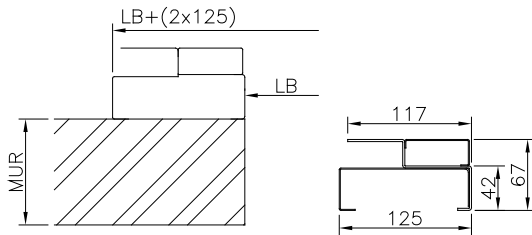

Type BS60, sliding door

**Approved for installation in the following fire wall types (EN 13501-2)**

- Concrete/lightweight<sup>1+2</sup>
- Masonry<sup>1+2</sup>
- Panel wall<sup>1+2</sup>
- Drywall<sup>1</sup>

**Handles**

**Allowed according to DS 1052.2: (DK)**

- Randi<sup>1</sup>
- D-line<sup>1</sup>
- MU<sup>1</sup>
- Knob handle<sup>1</sup>
- Pull handle<sup>1</sup>
- Emergency handle<sup>1</sup>
- Panic bar<sup>1</sup>
- Bowl/pull handle<sup>2</sup>
- DS handle<sup>2</sup>
- Edge handle<sup>2</sup>
- Torque handle<sup>2</sup>

**Allowed according to EN 13501-2: (EU)**

- Randi<sup>1</sup>
- D-line<sup>1</sup>
- MU<sup>1</sup>
- Knob handle<sup>1</sup>
- Pull handle<sup>1</sup>
- Emergency handle<sup>1</sup>
- Bowl/pull handle<sup>2</sup>
- DS handle<sup>2</sup>
- Edge handle<sup>2</sup>
- Torque handle<sup>2</sup>
- Panic bar<sup>1</sup>

<sup>1</sup> hinged door

<sup>2</sup> sliding door

**Accessories**

**Allowed according to DS 1052.2: (DK)**

- Door Closer<sup>1</sup>
- Threshold<sup>1</sup>
- Frame 4 sides<sup>1+2</sup>
- Access control<sup>1</sup>
- Personnel door<sup>2</sup>
- Extra lock<sup>1</sup>
- Door sensor<sup>1+2</sup>
- ABDL<sup>1+2</sup>
- Automation<sup>1+2</sup>

<sup>1</sup> hinged door

<sup>2</sup> sliding door

**Allowed according to EN 13501-2: (EU)**

- Silicone seals<sup>1+2</sup>
- Door closer<sup>1</sup>
- Threshold<sup>1</sup>
- Frame 4 sides<sup>1+2</sup>
- Window<sup>1+2</sup>
- Access control<sup>1</sup>
- Extra lock<sup>1</sup>
- Heating in the frame<sup>1</sup>
- Kick plate<sup>1+2</sup>
- Door selector<sup>1</sup>
- Door sensor (placed on the surface of the door/frame)<sup>1+2</sup>
- ABDL<sup>1+2</sup>
- ABDL magnet<sup>1+2</sup>
- Bottom guide/wall guide<sup>2</sup>
- Automation<sup>2</sup>
- Photocells in frame<sup>2</sup>
- Photocells front edge door leaf<sup>2</sup>
- Pedestrian door with level-free access<sup>2</sup>
- Window in pedestrian door<sup>2</sup>
- Door sensor (pedestrian door)<sup>2</sup>
- Door closer (pedestrian door)<sup>2</sup>
- Painting door leaf and frame<sup>1+2</sup>
- Automatic control with radar<sup>1</sup>
- Dog bolts<sup>1</sup>
- Cable loop (on the rear edge and on the front of the door leaf)<sup>1</sup>

**Further information or a specific offer?**

If you need further information or want a specific offer, please contact us by phone +45 86 92 11 71 or send an e-mail to [info@doorsystem.dk](mailto:info@doorsystem.dk).